

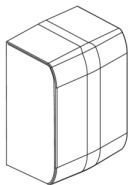

ATA205069010



**End cap, ATEHA, 20x50, pure white**

Product Datasheet

**Architecture**

Fixing mode	Clipped
-------------	---------

**Functions**

Overlapping	yes
Suitable for functional integrity according to DIN 4102-12	no

**Configuration**

Antibacterial treatment	no
-------------------------	----

**Connectivity**

Trunking coupling	without coupler
-------------------	-----------------

**Materials**

Colour	pure white
RAL colour	RAL 9010 - Pure white
Material	ABS
Material group	plastic
Type of surface treatment	untreated

**Dimensions**

Trunking height	20 mm
Trunking width	52 mm

**Equipment**

With protective film	no
----------------------	----

**Standards**

Approvals	EN50085-2-1
European directive RoHs	voluntary compliance

**Safety**

Protection index IP	IP40
Halogen free	yes
Impact strength	IK07

**Use conditions**

Operating temperature	-5...60 °C
-----------------------	------------

**temperatur**

Ambient temperature	-5...60 °C
---------------------	------------